

projektovanje
montaža
instalacija
testiranje
puštanje u rad
implementacija
INTEGRACIJA

HOTELSKE BRAVE

"PAMETNE SOBE"

sistemi sa "inteligentnim" hotelskim bravama i
ili kombinacijom čitač & el-brava

REŠENJA "KLJUČ U RUKE" ZA

HOTELE,
HOSTELE,
MOTELE,
DOMOVE,
...

Naš moto je:

Ništa nije konstantno, osim promene! Heraclites 490pne.

ASPEKT
system integration d.o.o.

za svu opremu
obezbeđeni
sertifikati



SOLUTIONS



www.aspekt.rs



UVOD – KRATKO O NAMA

Preduzeće ASPEKT System Integration d.o.o. bavi se integracijom sistema, razvojem software-a i uvozom odgovarajuće opreme u cilju zaokruživanja ponude na našem tržištu. Naš cilj je, pre svega, da ostvarimo blizak poslovni kontakt sa našim kupcima, da razumemo njihove zahteve i ciljeve koje oni žele da ostvare i istovremeno ponudimo najefikasnija rešenja i primenom najsavremenijih Informacionih Tehnologija. Mi obezbeđujemo POTPUNA REŠENJA, koja obuhvataju projektovanje, montažu, instalaciju, implementaciju, kao i integraciju raznolikih sistema, odnosno rešenja „ključ u ruke“. Verovatno o nama najbolje govore naše reference, stoga smo više detalja o nama publikovali na našim adresama:

www.aspektdoo.com

www.aspekt.rs

Reference: Agrobanka A.D. Hypo Aple Adria, Pireaus bank, Jughemija A.D., PKB Sistem, Kreditni biro Srbije, Vlada Srbije, Rudarsko-topioničarski basen Bor, Pravni fakultet Univerziteta u Beogradu, Dom učenika srednje železničke škole - Beograd, Milšped d.o.o., Autobuska stanica LASTA, Republički zavod za sport, Zavod za izradu novčanica i kovanog novca, NCA Consulting, JKP Gradske pijace - Kvantaška pijaca, LukOil, NESTLE, Skijalište Vučije, Hotel La Petit Piaf, Studentski dom "Košutnjak", ...

SISTEMI EVIDENCIJE I KONTROLE PRISTUPA VOZILA

Kompletna rešenja za komercijalna parkirališta, ne komercijalna, BUS stanice, fabričke kapije, portirnice,...

SISTEMI EVIDENCIJE I KONTROLE PRISTUPA LJUDI

Zaposlenih, posetilaca, putnika, ...

IDENTIFIKACIJA

- ID Kartice, bar code, bezkontaktno
- Otisak prsta, Geometrija lica
- Reg. broj automobile

TENIČKO OBEZBEĐENJE OBJEKATA

- Alarmni sistemi i
- Sistemi video nadzora

INTELIGENTNE HOTELSKE BRAVE

Kompletna rešenja za hotele, motele, domove ...

FISKALNA REŠENJA – OPREMA I SOFTWARE

Hotele, Restorane, Kafiće,
Maloprodajne objekte

MERENJE, REGULACIJA, OBAVEŠTAVANJE

GSM / SMS / GPRS Data Logger-i
GPS praćenje vozila



Ništa nije konstantno, osim promene! Heracleitus, 480 b.c.



OTKLUČAJTE

hotelsku sobu
bezkontaktom ključ-karticom (mifare), ili
otiskom prsta

**JEDNOSTAVNO, BRZO I LAKO ZA HOTEL,
MOTEL, HOSTEL, DOM, KANCELARIJU...**

Odaberite, jedan od dva, danas najčešće
primenjivana koncepta:

- "Inteligentnu" BRAVU, ili
- "kombinaciju" Čitač & el-brava

Odaberite između dva nosioca identifikacije,
odnosno: bezkontaktne (Mifare) Ključ-Kartice
"kreditnog tipa", ili "Otiska" prsta. Jasno, u
zavisnosti od namene vašeg objekta, njegove
strukture i željene funkcionalnosti.

OSTALO PREPUŠTITE NAMA, I MI ĆEMO
PROJEKTOVATI I IMPLEMENTIRATI SISTEM
KOJI RADI! Sve odabrano probajte kako
funkcioniše "u živo" u našem salonu na
panou.



A - KONCEPT "INTELIGENTNIH" BRAVA (sa, ili bez ožičenja),
naslonjen, "na kartice", ili otisak prsta čine:

- Inteligentne brave (Mifare 1, ili Otisak prsta)
- PC, enkoder kartica i software
- Upit kartica za "očitanje" događaja sa brave
- Kartice (Mifare 1)



B - KONCEPT "ČITAČ & EL-BRAVA" (sa obaveznim ožičenjem), naslonjen, "na kartice", ili otisak
prsta čine:

- Čitač pored vata (Mifare 1, HID, EMili Otisak)
- PC, enkoder kartica i software
- Kartice (Mifare 1, HID, FRID,...)



Po potrebi razmotrite i ŠTEDIŠU, odnosno uređaj koji "uključuje struju" samo
kad je gost u sobi, zatim info panel ispred sobe, regulaciju temperature u
sobi, svetlo dobrodošlice, SOS taster, hotelski sef, i ostalo sve do potpuno
"pametne" sobe.



Funkcionalnost kako odabranog koncepta tako i ostalih komponenti probajte odmah na
našem demo panou. Ref. Hotel Le Petit Piaf, Hotel MARIĆ, Motel ERA, Hotel ALBO, Hotel City,
Studentski dom Košutnjak, Dom učenika srednje železničke škole-Beograd....



“PAMETNA” HOTELSKA SOBA

je jednostavno „pamet“ smeštena na sobni PLC (kontroler), a koji obezbeđuje sa jedne centralne lokacije nadzor i upravljanje energetskim resursima, kao sto su na primer, osvetljenje, grejanje, klima, itd. Takode može da „monitoruje“, sistem kontrole pristpa, SOS sistem, alarmni sistem, PP sistem itd.

Sa stanovišta GOSTA jednini vidljivi elementi inteligentne hotelske sobe su elementi elektro galanterije. Istovremeno podesavanje svih željenih parametara upravljanja centralizovano je za sve inteligentne hotelske sobe u sistemu.

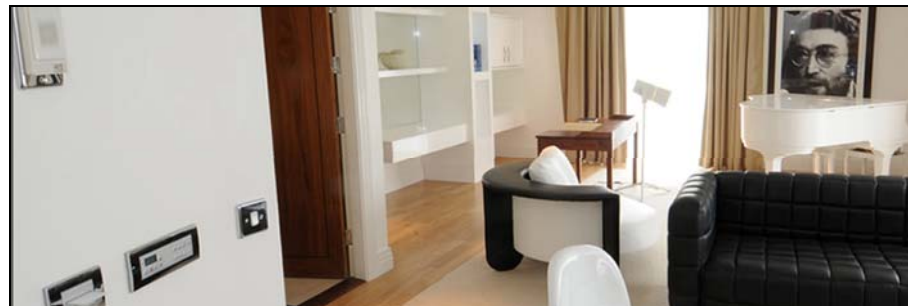
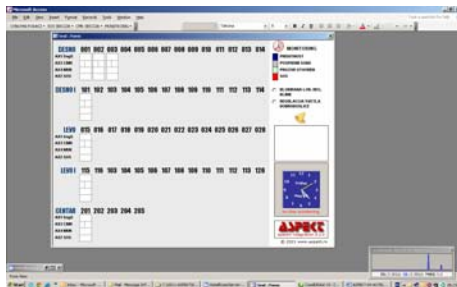

Na naš sistem inteligentne hotelske sobe nije teško „prikačiti“ elemente elektro galanterije raznorolikih proizvođača. Sledi nekoliko tipičnih elemenata “pametne” hotelske sobe:

INFO PANEL ispred vrata sobe sa tasterom za zvnce, i dva statusa, DND, odnosno NE UZNEMIRAVAJ, I CMR, odnosno POSPREMI SOBU, zatim:

ŠTEDIŠA, odnosno uređaj koji "uključuje struju" samo kad je gost u sobi

- SOS Potezač, za gosta u nevolji
- DND TASTER, NE UZNEMIRAVAJ, “Do Not Disturbe”
- CMR taster, POSPREMI SOBU, “Clean My Room”
- Regulacija temperature / lokalno / centralno
- ...

SOFTWARE

- Obezbeđen DLL za integraciju sa HMS software-ima i
- Interfaces za Fidelio





BRAVE – MODELI

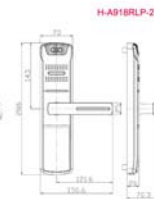
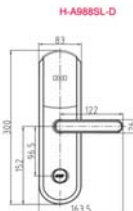
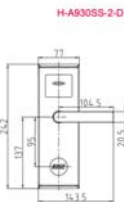
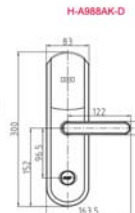
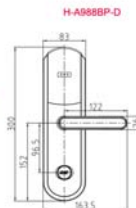
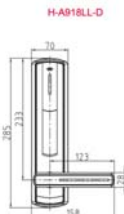
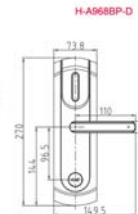
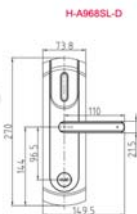
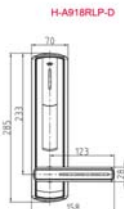

Detaljnije: www.aspekt.rs • Cene: office@aspekt.rs



TIPIČNO "BEŽIČNO" REŠENJE

Primer konfiguracije sistema "na kartice" zasistem hotelskih brava **BRAVBA H-A9A18SLD**

Kompletna mehanička brava sa motorizovanim mehanizmom za zatvaranje, šild sa kvakama, kompletnom elektronikom i beskontaktnim-čitačem



čipa. Opcije površinske obrade / vidi katalog. IZGLED: Klasičan, vrlo jednostavan, ali istovremeno vrlo otmen; MATERIJAL: Nerđajući čelik; ZAVRŠNA OBRADA: Nerđajući čelik, ili polirani mesing sa PVD zaštitom; TEHNIČKE KARAKTERISTIKE: Radni napon 6VDC sa 4 x AA baterije, iste "izguraju" i do 15000 ciklusa, odnosno i do 1,5 godine; Kod radnog napona od 4.8V pali se CRVENA lampica i signalizira potrebu da se baterije zamene. Od tog momenta iste mogu da rade bar još 10-tak dana; 1000 uzastopnih ciklusa normalnog "prinošenja" kartice bez GREŠKE; EEPROM u bravi čuva 228 poslednjih zapisa uključujući i otvaranje mehaničkim ključem. Broj, pozicija, kvalitet izrade i funkcionalnost JEZIČAKA na bravi u skladu sa američkim ANSI standardom 7777A, akogi je "tvrđi" od evropskog, više različitih modela: www.aspekt.rs

ŠTEDIŠA - UREĐAJ ZA ŠTEDNJU ENERGIJE (H-MAF6-S-ENG)

Uređaj koji obezbeđuje električnu energiju u sobi tek nakon što se kartica kojim je soba otključana ubaci u isti. Originalna tehnička apecifikacija: A30MF; Current:30A, 6600W, Delay time 5~10second; only Mifare card is issued by AV90 software valid for this lock system, only.



KARTICA (BEZKONTAKTNA) ZA GOSTA (Mifare 1K)

BELE ILI PREDŠTAMPANE Mifare KARTICE, pvc, ISO standard CR80, 85.40 x 56.00 x 0.76mm, Proxy, glossy



SERVISNA (UPIT) KARTICA - Kartica obezbeđuje prenos poslednjih 200 zapisa sa BRAVE na PC, brava evidentira (pamti) i otvaranje sistemskim ključem.

UREĐAJ ZA ENKODIRANJE KARTICA (KeyWinEncoder)

Mifare ENKODER kartica: Standard : ISO 1443 - 4 - 2001 & GB/T 182392 - 2000, Operating voltage: 5V(DC), Communication mode: RS232Product dimension: 85X85X75mm, Weight: 0.5kg

SOFTWARE (KeyWinSoftware)

software za izdavanje / enkodiranje kartica (hotelskih ključeva) kompletna aplikacija sa opcijama izdavanja: ■ kartica za gosta i ■ obezbeđuje ulazak u sobu ■ aktivira električnu energiju kada se ubaci u štetišu ■ obezbeđuje pristup svim ostalim sadržajima hotela, zatim: ■ master card ■ maid card ■ internal maintenance ■ external maintenance ■ on-line card ■ hardware test card ■ guest lock out card ■ temporary guest card ■ maksimalan broj brava u jednom sistemu je 65535 ■ [Na raspolaganju DLL za integraciju, kao i FIDELIO interfaces!](#)



HOTELSKA BRAVA: A - KONCEPT SERIJA: A-H / MIFARE 1 BEZKONTAKTNA KARTICA

Once you choose ASPEKT – OEM intelligent locks, means you have chosen the high quality to secure your valuable property and guests. The ASPEKT - OEMlocks offer you maximum safety and convenience, and help you to lower the operation costs. Features: Wireless system and stand-alone door lock: ASPEKT -



OEMintelligent lock RF CARD DOOR LOCK /HOTEL LOCK requires no wiring, adopts the RF card of USA TEMIC® company or RF card of PHILIPS® company to perform control function and unlocking function, is completely independent and stand-alone, is controlled by program resident in the lock and activated by cards which are coded by issuing computer. All of these make installation and maintenance becomes simple and easy. Adopt TEMIC® contactless RF card or MIFARE ONE® contactless RF card as keycard to enhance the security, reliability and convenience. The high performance integrate circuit with self-check function, automatically redress information mistake, inductive window automatically identify RF

card, and run with super low consumption, the static consumption is low to 12 uA. Lock hardware is made of strong steel, to create impact resistant ability. High security lockset with a hardened steel deadbolt, an anti-pick latch and 2 pieces of anti-friction latches. High quality stain stainless steel escutcheon reinforced by a steel plate for added security, High quality electrophoretic paint is used for solid brass handles. The handle feels smooth and reliable, and will always return firmly to the horizontal position. Easy to use: The lock is operated by handles from both the inside and the outside of the door. Outside handle is fixed while in locking state; the handle can be turned only in unlocking state. The Inside handle can be turned always. When ingress, the guest insert the keycard then the lock unlocked, turn the outside handle to open the door; when egress, the guest turn the inside handle directly to open the door. "Panic release": Deadbolt and latch are automatically retracted by inside handle for easy egress. Superb reliability and Low running cost: Low power consumption (the batteries can last for 10 months), high reliability and low maintenance help to keep the running costs low. Mechanical key: The separate emergency mechanical structure will allow the unlocking by the mechanical key in emergency. Keycards are limited by lock's clock, when the guest's lodging is out of the deadline, the keycard will be invalid, so the guest has to take the card to renew. Keycards are grouped into several levels to make the access authority clear. There are Master Card, Building Card, Floor Card, Waiter Card, and Guest Card. Hotel managers can modify the authority of each card according to actual need at any moment.. Master Card: can unlock all of the locks belong to the system without time's limited, even the deadbolt locks. Building Card: Can unlock the locks belong to corresponding building; cannot unlock the deadbolted locks, with time's limited. Floor Card: Can unlock the locks belong to corresponding floor; cannot unlock the deadbolted locks, with time's limited. Guest Card: For the guest to open the room he/she lodges in within the specifying period of time. Normal- open state can be set for meeting. Avoid waiter's incautious disturb: If the guest turns out the deadbolt inside the room, when insert keycard (except Master Card) the LED will flash in red and green alternately to remind the waiter that someone is inside the room. Report the loss of keycard: Even if your keycard is lost, you can keep quiet, the lost keycard can be invalidated by simple card operations on the lock. The lock memorizes the latest more than 200 access records to be checked for case, guarantee the security management. The elegant printed card help accent the distinction of the hotel. User-friendly and Compatible software: Specially utilize a WINDOWS® software platform to design the management software make use easy. Offers software interfaces (DLL) to make the lock management software can be connected to other hotel management system. Multi-purpose card can be developed from the keycard, to support lock system, power system, safe, lift, hotel consumption system, and so on. Detaljnije:

www.aspekt.rs • Cene: office@aspekt.rs



ČITAČ : B - KONCEPT



RFID SMART CARD READER / TERMINAL Waterproof Access control

ACAM100 RFID Smart Card Access control system, It's Waterproof with RS232 / 484, TCP/IP interface, and 3 Color LED Indicators (Blue, Red and Green) with audible beep, etc... RFID Smart Card Waterproof Access control System

FEATURES:

Elegant design with Acrylic plastic
Revolutionary products in industry with TCP/IP interface, avoid RS485 communication and low speed for transferring data, standalone or network deployment
Protect the data with encrypted technology
Professional access control function: 50 time zones, 5 groups, 10 open door combination, support multi users entry
Built-in relay contacts lock, alarm, door sensor & exit button
Wiegand input & output enables Master/Slaver access control
Embedded web server: support browser to inquire access data at local or remote
No LCD and no keypad enhance the functions of waterproof and dustproof
Professional access control software for management

BENEFITS:

Card Holders: 30,000 cards / Transaction Capacity: 50,000 events
Read Range: 5-10 cm, Reading Time (Card): <30ms
Platform: ZEM500 (Embedded Linux O/S).
Communication: RS232/484, TCP/IP.
Built-in Relay for Door Sensor, alarm, EM-Strike/Magnetic lock, exit button.
26 bit Wiegand Input/Output.
LED Indicator: 3 Color LED Indicators (Blue, Red and Green) with audible beep
Blue: Normal standby mode; Red: Access denied; Green: Access granted
Power/Current: DC12V/ Max. 3 A
Dimension (W x H x T): 153x95.5x35.5mm
Operating Temperature: 0-45°C / Operating Humidity: 20%-80%
Optional functions: Mifare/HID/ iClass card, Web server, Anti-pass back

- Detaljnije: www.aspekt.rs
- Cene: office@aspekt.rs



ELEMENTI „PAMETNE“ SOBE

ZVONCE / DND & CMR INFO DISLPY

DND (ne iznemiravaj) &
CMR (spremite moju
sobu) ;

Door bell switch with No
Disturb and Please Clean
function; Performance
Index: Function: Please
Clean, No Disturb and Door



Bell Switch display function; Working Voltage:
AC 220V±10%; Cover Material: Fire-resistant
PC; Color: White ; Dimension: 86(L) x 86(W) x
30 (H) mm

ŠTEDIŠA: 03A09M (ASPEKT OEM)

(Energy Saving Switch)

Mifare 1 RF Card Energy-
Saving Switch / ISIC Card
version Rev 1.15;
Performance Index:

Working Voltage: AC
220V±10%; Load Working

Current: 30A; Total Load Power: 6600W;
Static Consumption: 0.01W; Delay Time:
About 15 Seconds; No-working Situation:



Indicate in red; Cover Material: Fire-resistant PC; Color: White; Weight: 200g; Dimension: 85(L) x 85(W) x 42(H) mm; Usage: When entering the rooms, the guests have to insert the room card into the Energy Saving switch to turn on the illumination system. While leaving the room, the guest draw the room card; then the power supply will be shut off by the Energy Saving Switch about 15 seconds later. The delay function is very important in the Energy Saving Switch, without it, the guests have to leave the room in the dark. The consumption of the illumination system in each room in the hotel is about 2000 watt. If the guests forget to turn off all the electric appliances when they leave the room, which will be a great waste and it's very insecure. While their leaving, it is difficult for the waiter to know whether the lamps are turned on or not in the rooms. So we specially developed the Energy Saving Switch for the hotel to save the substantive regrettable consumption.

ŠTEDIŠA: 99A08 (ASPEKT OEM)

(Energy Saving Switch)

Usage : When entering the rooms, the guests have to insert the room card into the Energy Saving Switch to turn on the illumination system. While leaving the room, the guest draw the room card; then the power supply will be shut off by the Energy Saving Switch about 15 seconds later. The delay function is very important in the Energy Saving Switch, without it, the guests have to leave the room in the dark. The consumption of the illumination system in each room in the hotel is about 2000 watt. If the guests forget to turn off all the electric appliances when they leave the room, which will be a great waste and it's very insecure. While their leaving, it is difficult for the waiter to know whether the lamps are turned on or not in the rooms. So we specially developed the Energy Saving Switch for the hotel to save the substantive regrettable consumption. Performance Index: Working Voltage : AC 220V±10%; Load Working Current: 30A, Total Load Power: 6600W; Static Consumption: 0.01W; Delay Time: About 15 Seconds; No-working Situation: Indicate in red; Cover Material: Fire-resistant PC; Color: White ; Weight: 200g; Dimension: 85(L) x 85(W) x 42(H) mm



SERIJA 9000 / OTISAK PRSTA



Fingerprint & keypad H-A9000(RL-2-F)

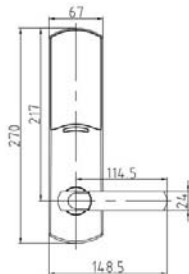

WORK THEORY: ASPEKT OEM fingerprint lock 9000 bases on living body fingerprint recognition technology which is the most advanced technology over the world. The capture area is a semiconductor sensor made of elastic fine porcelain, which has the function of capturing the texture characteristic of fingerprint. When finger presses on it, the capturer collects the fingerprint after one scan. **FUNCTIONAL CHARACTERISTICS:** 60 fingerprint keys can open and close door lock freely; Automatic power off after a period of no action and manual reset; Set or delete fingerprint keys on

the users own wish; Standby mechanical keys for emergency; The surface of shell is chrome plated and can never wear out; Low power consumption, and particular technology of energy conservation can protract the longevity of the product.

Additional function:

1. Always open
2. Switch trigger to unlock
3. Wireless light control
4. Alert signal

TECHNICAL CRITERIA:

Fingerprint Recognition Time: $\leq 1.2s$ / Fingerprint Capturing Time: $\leq 0.2s$

Fingerprint Permissible Variation: $< \pm 5mm$ / Permissible Angle of the Finger: $< \pm 180$ degree

FAR (False Acceptance Rate): $< 0.0001\%$ / FRR (False Rejection Rate): $< 0.1\%$

Fingerprint Capacity: 120pcs (60person, can be extended 200pcs fingerprint max)

Working Temperature: $-18^{\circ}\sim 55^{\circ}$ / Working Humidity: $0\%\sim 99\%$

Power Supply: 4pcs AA Alkaline Batteries

Fingerprint Resolution: 500DPI / Fingerprint Collecting Window Size: $> 18mm \times 22mm$

Battery Life: unlocking more than 35000 times, can last for more than one year

Collecting Life: 1,000,000 times

RANGE OF APPLICATION: Home, community, villa, office, laboratory, classified papers office, information center, factory, storehouse, financial system of the bank, store of valuables, star-rated hotel, and other places require safety.

Cover Size: 270mm(Height) x 67mm(Width) x 39mm(Thickness)

Mortise size: 204mm(Height) x 106mm(Width) x 23mm(Thickness)

Detail:

Adopt INTEL core technology from USA Korean style, Japanese finish technology. Famous fingerprint reader, work fast and stable. Large fingerprint collection area, large angle to collect fingerprint.. Protection cover protect the reader and keypad.. Outlet for external 9V battery. Mechanical Key for emergency. Max 400 PCS fingerprint.



KANCELARIJSKE BRAVE



Series: H-A6000RL

RF Card+keypad

Adopt INTEL core technology from USA- H-A6000 Series adapts to standard single latch; Fingerprint lock, just put the finger directly, no need to touch any key in advance. Press 4 digitals password with sound and LED indication. Initiator of single latch lock with deadbolt inside; Outlet for external battery. Mechanical key for emergency; Optional check access records, communicate with computer on-line. Outlet for external battery. Mechanical key for emergency; Fingerprint, keypad, fingerprint + keypad, pairs of fingerprint optional modes etc. Unique ID user, can delete or add the user. Always-open function for meeting room or public room. Best replacement of the traditional tubular lock/knob lock. Special suitable for home, office, school and government.



H-A9000RL-Mifare Card & KeyPad

Series: H-A9000RL

RF Card (Mifare) & Keypad

Detail: Korean style, Japanese finish technology. Famous fingerprint reader, work fast and stable. Protection cover protects the reader and keypad. Outlet for external 9V battery. Mechanical Key for emergency.



ON LINE BRAVE – OTISAK PRSTA

(LAN brave)



Serija: FAP 6800 / OTISAK prsta

MODEL: FAP6800-1-TCP / NETWORK

Model: FAP6800-3C-BT / Description: Europe style, brilliant and practical. Biometric technology ensures high security. Sweeping finger, with very high speed. Bluetooth technology brings convenient management and leads the trend of security products. Standard mechanical key override. Low FAR and low FRR. Support TCP/IP network (model No. is FAP6800-1-TCP). High capacity with 100 users for office, home and apartment use. Color: Silverč Working Humidity: -10C to +50Cč User Capacity: 100 usersč Material: fine casting stainless steelč Packing: 6pcs/ctn(340*320*390mm)

FAR < 0.0001%; FRR < 0.01%; Resolution: 450DPI; Fingerprint lock installing flash (FP78xx, 68xx); Manual of PC Software for Bluetooth Fingerprint Lock V4; Manual of PDA Software for Bluetooth Fingerprint Lock V4; PC Software for Bluetooth Fingerprint Lock; PDA Software for Bluetooth Fingerprint Lock

SERIES: FAP60006800 / OTISAK PRSTA

FAP6000Q-3C-BT / Description: Very easy to install or replace your old locks. Biometric technology ensures high security. Sweeping finger, with very high speed. Keeloq-code electronic key for emergent access. Bluetooth technology brings convenient management and leads the trend of security products. Patented struture lockheart, more stable and reliable for daily use. Low FAR and low FRR. Patented appearance design. High capacity with 100 users for office, home and apartment use.

Material: Alloy /Color: Gold or Silver / Working Humidity: - 10C to + 50C
User Capacity: 100 users / Identification Time: < 2 seconds / FAR: <0.0001% / FRR: < 0.01%
Resolution: 450DPI



INTELIGENTNE BRAVE ZA ORMARICE

CABINET LOCK

H-AYR01BS

H-AYR01G

H-AAR01SL



Namena

GARDEROBNI ORMARIĆI ZA

- Bazene zatvorene
- Otvorene, natkrivene
- Wellness centre
- Aqua Parkove
- Fabričke garderobe
- Ostale garderobe

Napajanje: 3 x AA alkaline baterije
Vek trajanja baterija: oko 1 godine

FUNKCIONALNE KARTICE

1. MASTER KARTICA, obezbedjuje prijavljivanje GOST KARTICE
2. GOST KARTICA – kapacitet 15 po jednoj bravi

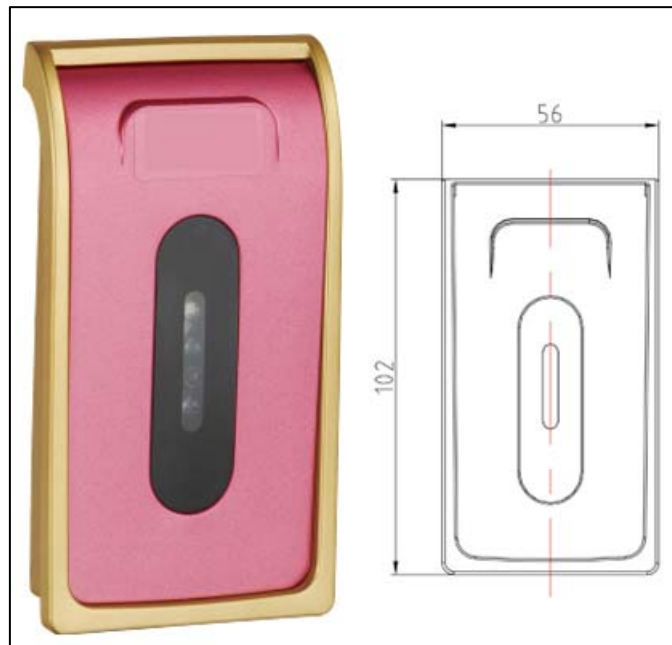



ŠIFRA & KLJUČ

Model No.: EAE-SA180A



- Two levels of code management: Guest code & Master code
- Override keys provided for emergency opening
- Powder coating surface
- Two fixing holes on the back and two on the bottom
- Floor carpet and anchor bolts included
- Various colors are available

a. External size (mm):

H180*W280*D200

b. Thickness (mm):

- Body: 2
- Door: 5

c. Weight (kg): 7

d. LED display

e. Motor drive

f. Two groups of code:

- Guest code
- Master code

g. Override key for emergency opening

h. 200pcs of opening record can be checked on the screen and printed out via portable printer.

i. Intellectual management controller can be used for emergency opening